

LAKER

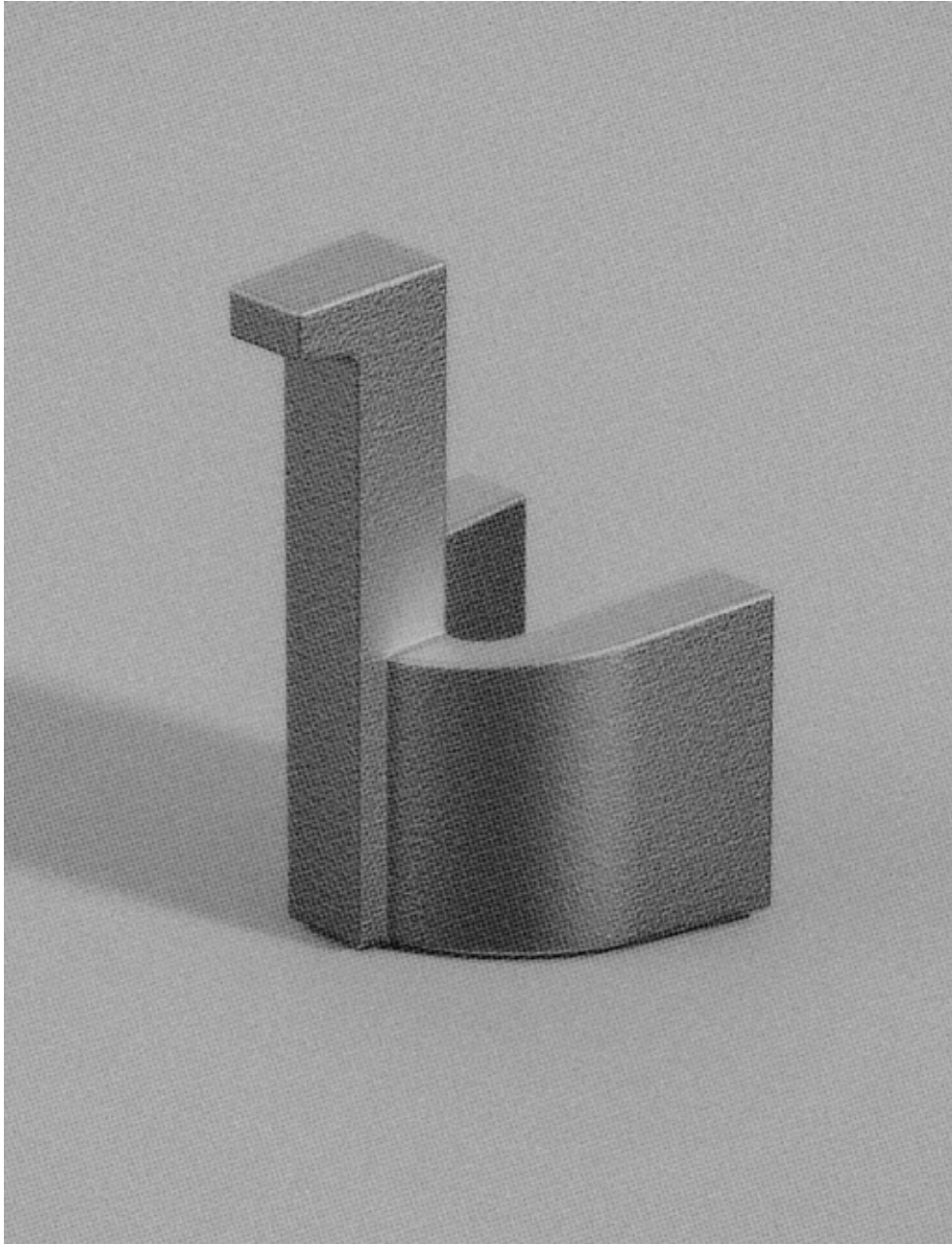

Lug

Product Data Sheet

Lug

LKR-LUG-Z

Description

A door stop. Lug has been designed to ensconce the blade edge of the door in an embrace, holding it firmly in place with its prodigious weight whilst minimising its impact on the path of travel.

Suitable for doors up to 5.5cm wide

Design : David Caon & Henry Wilson 2021

Dimensions

Width	10cm		3.9"
Depth	9.8cm		3.8"
Height	15cm		5.9"
Weight	2.15kg		4.73lbs

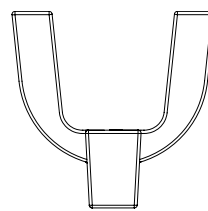

10

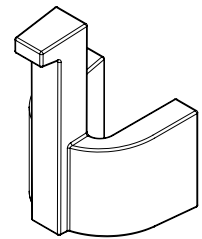

9.8

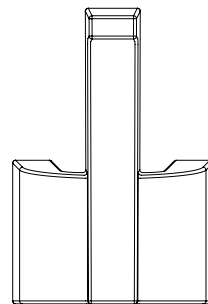

15

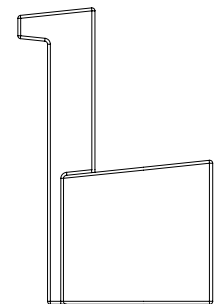

Construction

The result of a brutally industrial process, Lug is cast in iron and then zinc plated to prevent corrosion. A die-cut felt pad is supplied for use on delicate floor surfaces (such as wooden floorboards or painted floors)

Imperfections in the surfaces caused by the manufacturing process are to be expected and inherent in the visual language of this object. No two are exactly alike.

Country of Origin

Australia

Production Lead Time

If not in stock, production lead time is 6 weeks

Care Guide

Lug requires little attention. It has been designed to be abused. The zinc surface will rub and fade with excessive contact, lending to the honest aesthetic. To clean, wipe down with a damp cloth.

Materials

Cast Iron

Felt (foot)

Colour and Finish

Zinc plated iron



Zinc iron

LAKER



Lug

Product Data Sheet

LAKER

For enquiries, please visit us at

www.laker.studio
info@laker.studio
laker.studio